

Prime Beverly Hills Retail Space for Sublease

9607 S Santa Monica Blvd, Beverly Hills, CA 90210



Property Information

Bldg. Sq Ft: ± 855 SF

Term: Through April 30, 2014
Longer Term May be Available

Rental Rate: \$6,000/month + NNN

Parking: Abundant Off-site Public Parking

Property Highlights

- Strong Beverly Hills Golden Triangle Location (S Santa Monica Blvd. between Bedford Drive and Camden Drive)
- Built-out Nail Salon Space
- Perfect Creative Use Space
- Nearby upcoming Annenberg Center for Performing Arts & City Council of Beverly Hills Offices
- Within Blocks of Rodeo Drive, the Montage Hotel, & the Beverly Wilshire Hotel
- Neighboring Tenants Include: **Sprinkles Cupcakes, Le Pain Quotidian, Crumbs Bakery, Crustacian and K Chocolatier**
- Located in the Same Building as Panini Café, Menchie's Frozen Yogurt and Chroma

For Additional Information, Contact:



Commercial Asset Group, Inc.
 9606 Santa Monica Blvd. 2nd Floor
 Beverly Hills, California 90210
 T 310.275.8222 F 310.275.8223
 www.cag-re.com Lic. 01876070

David J. Ickovics
 Principal
 D 310.272.7380
 dji@cag-re.com
 Lic. 01315424

Ryan M. Schimel
 Associate
 D 310.272.7384
 ryans@cag-re.com
 Lic. 01879511

These materials are based on information and content provided by others, which we believe are accurate. No guarantee, warranty or representation is made by Commercial Asset Group, Inc. or its personnel. All interested parties must independently verify accuracy and completeness. As well, any projections, assumptions, opinion, or estimates are used for example only and do not represent the current or future performance of the identified property. Your tax, financial, legal and toxic substance advisors should conduct a careful investigation of the property and its suitability for your needs, including land use limitations. The property is subject to prior lease, sale, change in price, or withdrawal from the market without notice.

Prime Beverly Hills Retail Space for Sublease

9607 S Santa Monica Blvd, Beverly Hills, CA 90210

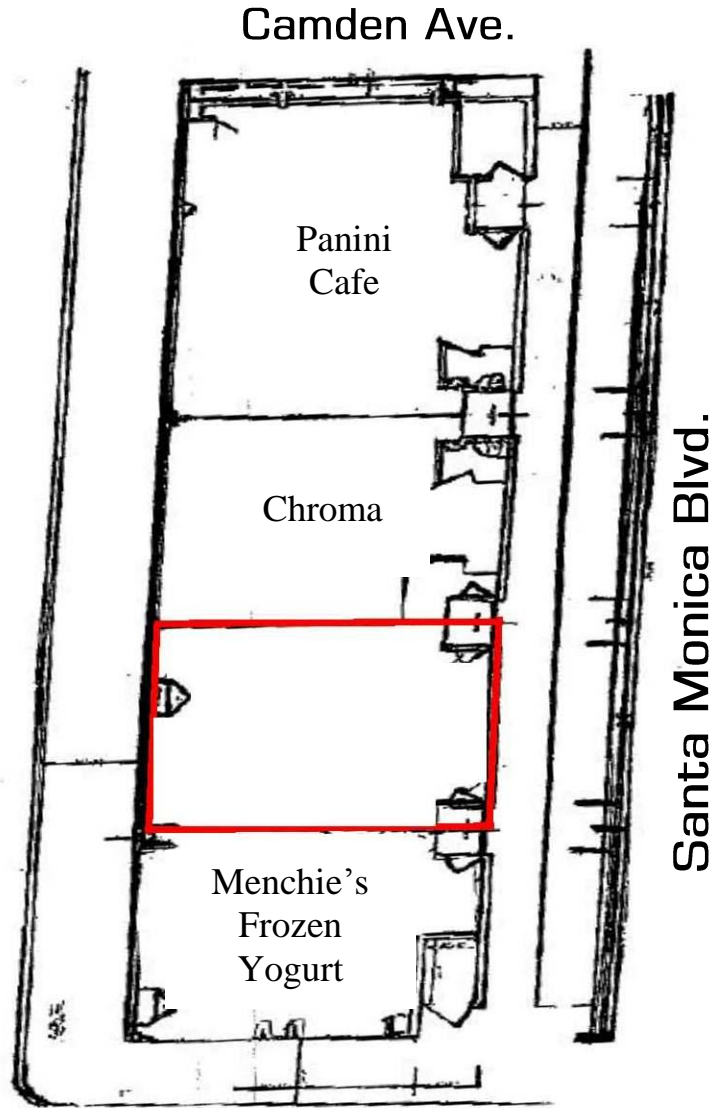

For Additional Information, Contact:



Commercial Asset Group, Inc. :
9606 Santa Monica Blvd. 2nd Floor :
Beverly Hills, California 90210 :
T 310.275.8222 F 310.275.8223 :
www.cag-re.com Lic. 01876070 :

David J. Ickovics :
Principal :
D 310.272.7380 :
dji@cag-re.com :
Lic. 01315424 :

Ryan M. Schimel :
Associate :
D 310.272.7384 :
ryans@cag-re.com :
Lic. 01879511 :

These materials are based on information and content provided by others, which we believe are accurate. No guarantee, warranty or representation is made by Commercial Asset Group, Inc. or its personnel. All interested parties must independently verify accuracy and completeness. As well, any projections, assumptions, opinion, or estimates are used for example only and do not represent the current or future performance of the identified property. Your tax, financial, legal and toxic substance advisors should conduct a careful investigation of the property and its suitability for your needs, including land use limitations. The property is subject to prior lease, sale, change in price, or withdrawal from the market without notice.

Prime Beverly Hills Retail Space for Sublease

9607 S Santa Monica Blvd, Beverly Hills, CA 90210



Santa Monica Blvd. to the West



Santa Monica Blvd. to the East



For Additional Information, Contact:



Commercial Asset Group, Inc. :
 9606 Santa Monica Blvd. 2nd Floor :
 Beverly Hills, California 90210 :
 T 310.275.8222 F 310.275.8223 :
 www.cag-re.com Lic. 01876070 :

David J. Ickovics :
 Principal :
 D 310.272.7380 :
 dji@cag-re.com :
 Lic. 01315424 :

Ryan M. Schimel :
 Associate :
 D 310.272.7384 :
 ryans@cag-re.com :
 Lic. 01879511 :

These materials are based on information and content provided by others, which we believe are accurate. No guarantee, warranty or representation is made by Commercial Asset Group, Inc. or its personnel. All interested parties must independently verify accuracy and completeness. As well, any projections, assumptions, opinion, or estimates are used for example only and do not represent the current or future performance of the identified property. Your tax, financial, legal and toxic substance advisors should conduct a careful investigation of the property and its suitability for your needs, including land use limitations. The property is subject to prior lease, sale, change in price, or withdrawal from the market without notice.